

helping
architects and
builders achieve
energy ratings of
up to 10-stars



... by making Australia's most energy efficient windows



ECO Façade Curtain Wall

Since 1990, Paarhammer windows & doors have been setting the benchmark in energy efficiency in Australia.

Façades offer distinct advantages, allowing a choice of glass solutions for the right light levels and insulation, thereby significantly reducing artificial lighting as well as heating and cooling costs by up to 80% or more. Constructed with the strength, warmth and energy efficiency of timber inside and aluminium clad for zero maintenance outside. The visible aluminium profile is clipped onto the outside, is only 50mm wide, available in a variety of colours, and guarantees a hardwearing and maintenance free outer skin.

The ECO Façade is pre-fabricated in our manufacturing plant and we have developed a simple site assembly system, saving time and money. The internal construction is made in timber or engineered timber and can be load bearing.



Custom-made

Each glass panel operates independently enabling the ECO Façade to accommodate inserts of double or triple glazed doors, and openable and fixed windows, operated manually or motorised. Doors can be single, French, bi-fold or sliding, and fingerprint recognition or inclusion into automation systems may be incorporated. A variety of finishes and timbers to choose from, including FSC® (Forest Stewardship Council®) certified timbers.

Humans respond positively to the internal timber as it is visually warm and contributes to a positive, relaxed atmosphere. Wood contributes to humidity control, controls air-borne contaminants and emits very few, if any, harmful vapours. It also stores carbon for life.



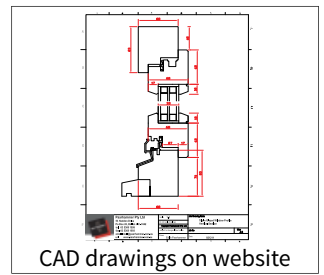
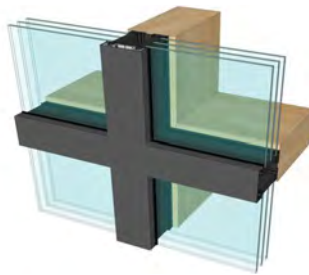

CAD drawings on website

Energy efficiency

Paarhammer ECO Façades are high performing and can reduce energy use by up to 83% with U-values from a low 0.8. Glass units between 24mm and 48mm to customer's specifications are inserted.

All different glass combinations including Low-E, tinted, self-cleaning etc are available to choose from to make up double or triple glazed units. The contact pressure of the glazing caskets are regulated by sealing profiles.



With Paarhammer you can have it all: the warmth of timber inside and no-maintenance aluminium outside, the health and cost benefits of energy efficiency, all packed in a very attractive customised ECO Façade.



Award for ECO Façade

Featured first at Designbuild 2014, the ECO Façade wins the Selector Best New Product Award 2014.

This award encourages innovation, development and improvement of products for use in architectural projects. The judges for 2014 include Clare Cousins, founding director of Clare Cousins Architects; Jeremy McLeod, founding director of Breathe Architecture; and Nick Deans, project professional at Woods Bagot. 'Jury comment: Paarhammer's ECO Façade system was a standout product ...and their proactive sustainable practices are also highly commendable. This is a highly resolved and desirable glazing system.'



REGISTERED Building Practitioner

Paarhammer Pty Ltd				Cool	Heat	Total Window - AFRC			
Updated 29-Aug-2013				%	%				
Window ID	Glazing	Cooling Stars	Heating Stars			Uw	SHGC	Tvw	Aif Inf
Scandinavian Fir Fixed Window - Triple Glazed									
PAR-009-01	4/12Ar/3/12Ar/4	★★★★	★★★★★★	55%	65%	1.7	0.52	0.56	0.05
PAR-009-02	4PThrm/12Ar/3PThrm/12Ar/4PThrm	★★★★★★	★★★★★★	79%	58%	0.8	0.23	0.40	0.05
PAR-009-03	4SB70XL/12Ar/3SB70XL/12Ar/4SB70XL	★★★★★★	★★★★★★	83%	52%	0.9	0.16	0.28	0.05

We are committed to a sustainable future with architectural flexibility and style.

Paarhammer Pty Ltd
53 Haddon Drive - PO Box 26
Ballan Victoria 3342
Australia

tel: 03 5368 1999
fax: 03 5368 1993
email: mail@paarhammer.com.au
direct call: 1300 655 920



no draft no fire no noise

www.paarhammer.com.au

